

*Claudio G. De Angelis*  
COURSE DIRECTOR

6th

**EUS-ERCP connection:  
the “EURCP” concept**  
An International Endoscopic  
Hybrid EGEUS event



NH Hotel Torino Centro  
Turin 15-17 Dec 2022



Dear friends & colleagues,

We are delighted to invite you to the sixth edition of our International EGEUS Live Course, EUS-ERCP connection: The "EURCP" concept. The first edition was held in 2012 and the course was only a national one, but it attracted more than 60 participants. In 2014, the Course shifted towards an International one and we collected more than 150 enthusiastic participants. In 2016 and 2018, the third and fourth editions were very successful with more than 220 participants.

Then came the COVID 2019 pandemic and in 2020, the Course has been a great success but completely digital, with more than 700 online participants, from more than 60 countries worldwide and live connections from a lot of centers both in Italy and abroad (Rome, Milan, Budapest, Hong Kong, Copenhagen, Cairo and Mumbai). But in 2022 our hope is to leave behind the pandemic and meet again all together in person, without abandoning the great possibilities of a worldwide expanded audience. Since our first meeting it has been our goal to highlight the most updated developments in EUS and ERCP and their combined use, summed up in the new concept of EURCP which includes a whole world of new ideas and ways to approach the biliopancreatic pathology from both a diagnostic and therapeutic point of view. All this together with the new diagnostic and therapeutic ancillary techniques and newly developed devices, such as peroral cholangioscopy and pancreatoscopy, intraductal ultrasound and probe-based confocal laser endomicroscopy, the new LAMS and more. Participants will be able to see live demonstrations of high quality EUS +/-FNA/FNB procedures, EUS-guided therapeutic and ERCP techniques and at the same time will have a fantastic view into the most recent advances in diagnostic and therapeutic endoscopic management of patients with biliopancreatic diseases. All the procedures will be performed by our fantastic guests and local Faculty.

The theoretical part of the Conference will encompass a varied and comprehensive program of lectures, discussions and video presentations by experts from different countries in addition to a Symposium for Nurses on Saturday, December, 17th. The official language of the Course will be English. The Congress venue will be in the ancient center of Turin, conference centre: Hotel NH Torino Centro and the live in Molinette Hospital. The renewed possibility of an in person participation will also allow you to enjoy the fantastic tourism opportunities offered by Turin (shopping, museums, other artistic venues, high quality restaurants) and the fantastic Turin Christmas atmosphere, as in the previous editions, pre-COVID era. It is an honor and a pleasure to invite you to participate in person in Turin or at least online, to our hybrid event: the 6th edition of the EUS-ERCP connection: the EURCP concept, International EGEUS live Course, on December 15-17, 2022.

Claudio G. De Angelis  
Course Director

# 6th

## **EUS-ERCP connection: the "EURCP" concept An International Endoscopic Hybrid EGEUS event**

**NH Hotel Torino Centro  
Turin 15-17 Dec 2022**



# SCIENTIFIC RATIONALE

Aim of the Course is to highlight the most updated developments in EUS and ERCP and their combined use, summed up in the new concept of EURCP which includes a whole world of new ideas and ways to approach the biliopancreatic pathology from both a diagnostic and therapeutic point of view. All this together with the possibility of a deep insight into the new diagnostic and therapeutic ancillary techniques and newly developed devices, such as peroral cholangioscopy and pancreatoscopy, intraductal ultrasound and probe-based confocal laser endomicroscopy, the new LAMS and more. Participants will be able to see live demonstrations of high quality EUS +/-FNA/FNB procedures, EUS-guided therapeutic and ERCP techniques and at the same time will have a fantastic view into the most recent advances in diagnostic and therapeutic endoscopic management of patients with biliopancreatic diseases. The theoretical part of the Conference will encompass a varied and comprehensive program of lectures, discussions and video presentations by experts from different countries and the participants will be able to experience and learn about the most important hepato-biliary and pancreatic pathologies and their up-to-date management both clinical and endoscopic.

# INTERNATIONAL FACULTY

Kenneth Binmoeller ■ San Francisco (USA)  
László Czako ■ Szeged (Hungary)  
Pierre Deprez ■ Brussels (Belgium)  
Vinay Dhir ■ Mumbai (India)  
Mohamed Ali El Nady ■ Cairo (Egypt)  
Rodica Gincul ■ Lyon (France)  
Cem Kalayci ■ Istanbul (Turkey)  
Mitsuhiro Kida ■ Kitasato (Japan)  
Amit Maydeo ■ Mumbai (India)

Helmut Messmann ■ Augsburg (Germany)  
Manu K. Nayar ■ Newcastle (UK)  
Laurent Palazzo ■ Paris (France)  
Andrada Seicean ■ Cluj-Napoca (Romania)  
Leonardo Sosa Valencia ■ Strasbourg (France)  
María Teresa Soria ■ Zaragoza (Spain)  
Peter Vilmann ■ Copenhagen (Denmark)

# ITALIAN FACULTY

Andrea Anderloni ■ Pavia  
Paolo G. Arcidiacono ■ Milano  
Luca Barresi ■ Palermo  
Helga Bertani, ■ Modena  
Paolo Bocus ■ Negrar (Verona)  
Elisabetta Buscarini ■ Crema  
Guido Costamagna ■ Roma  
Marco Daperno ■ Torino  
Claudio G. De Angelis ■ Torino  
Francesco M. Di Matteo ■ Roma  
Roberto Di Mitri ■ Palermo  
Carlo Fabbri ■ Forlì-Cesena  
Pietro Fusaroli ■ Imola (Bologna)

Armando Gabbrielli ■ Verona  
Alberto Larghi ■ Roma  
Aldo Manca ■ Cuneo  
Dario Mazzucco ■ Rivoli (Torino)  
Massimiliano Mutignani ■ Milano  
Nico Pagano ■ Novara  
Maria Caterina Parodi ■ Genova  
Alessandro Repici ■ Rozzano (Milano)  
Rodolfo Rocca ■ Torino  
Giorgio M. Saracco ■ Torino  
Ilaria Tarantino ■ Palermo  
Thomas Togliani ■ Mantova

# LOCAL FACULTY

Mauro Bruno ■ Torino

Stefania Caronna ■ Torino

Wilma Debernardi Venon ■ Torino

Silvia Gaia ■ Torino

Marcantonio Gesualdo ■ Torino

Chiara Giordanino ■ Torino

Alessandro Lavagna ■ Torino

Marco Sacco ■ Torino

# ANESTHESIOLOGISTS

## TEAM

Roberto Balagna ■ Torino

Christoph Meier ■ Torino

Rosalba Oliva ■ Torino

Andrea Pusineri ■ Torino

# PATHOLOGISTS

## TEAM

Denisa Petronela Filip ■ Torino

Francesca Maletta ■ Torino

Angelo Panio ■ Torino

Mauro Papotti ■ Torino

Chiara Pitino ■ Torino

# SCIENTIFIC PROGRAM

**DAY 1**

**Thursday | 15 December 2022**

**08.00** Registration CME

**08.30** Welcome words and introduction to the Course  
*Claudio Giovanni De Angelis ■ Giorgio M. Saracco*  
ESGE President Welcome words  
*Helmut Messmann*

**08.45** **LIVE SESSION 1**

Live transmission from Turin: *Molinette Hospital*

Chairs: *Rodica Gincul ■ Manu K. Najjar ■ Giorgio M. Saracco*

Live operators and Tutors: *Andrea Anderloni, Paolo Giorgio Arcidiacono, Helga Bertani, Kenneth Binmoeller, Mauro Bruno, Stefania Caronna, Guido Costamagna, Wilma Debernardi Venon, Francesco Maria Di Matteo, Vinay Dhir, Carlo Fabbri, Pietro Fusaroli, Silvia Gaia, Chiara Giordanino, Mitsuhiro Kida, Alessandro Lavagna, Amit Maydeo, Nico Pagano, Laurent Palazzo, Ilaria Tarantino, Thomas Togliani, Peter Vilmann.*

Anesthesiologists Team: *Roberto Balagna, Christoph Meier, Rosalba Oliva, Angelo Panio, Andrea Pusineri*

Pathologists Team: *Mauro Papotti, Francesca Maletta, Chiara Pitino, Denisa Petronela Filip*

**11.00** Open Coffee

## 11.00 LIVE SESSION 2

Live transmission from Turin: *Molinette Hospital*

Chairs: *László Czakò ■ Helmut Messmann ■ Maria Teresa Soria*

Live operators and Tutors: *Andrea Anderloni, Paolo Giorgio Arcidiacono, Helga Bertani, Kenneth Binmoeller, Mauro Bruno, Stefania Caronna, Guido Costamagna, Wilma Debernardi Venon, Francesco Maria Di Matteo, Vinay Dhir, Carlo Fabbri, Pietro Fusaroli, Silvia Gaia, Chiara Giordanino, Mitsuhiro Kida, Alessandro Lavagna, Amit Maydeo, Nico Pagano, Laurent Palazzo, Ilaria Tarantino, Thomas Togliani, Peter Vilmmann.*

Anesthesiologists Team: *Roberto Balagna, Christoph Meier, Rosalba Oliva, Angelo Panio, Andrea Pusineri*

Pathologists Team: *Mauro Papotti, Francesca Maletta, Chiara Pitino, Denisa Petronela Filip*

14.00 Lunch

## 15.00 THEORETICAL SESSION 1: OPENING LECTURE

Introduction (Presenter): *Andrada Seicean*

*EUS/ERCP convergence = the EURCP concept: present and future*

*Claudio Giovanni De Angelis*

## THEORETICAL SESSION 1: TECHNICAL ISSUES

Chairs: *Dario Mazzucco ■ Rodolfo Rocca ■ Leonardo Sosa Valencia*

15.25 **EUS INSTRUMENTS AND DEVICES: WHAT'S NEW?**

*Thomas Togliani*

15.40 Discussion

15.45 **ERCP INSTRUMENTS AND DEVICES: WHAT'S NEW IN THE ERA OF THE PANDEMIC AND OF THE INCREASING OUTBREAKS OF MDRO INFECTIONS?**

*Armando Gabbrielli*

16.00 Discussion

16.00 Open Coffee

16.05 **PERORAL CHOLEDOSCOPY AND PANCREATOSCOPY: INDICATIONS, TECHNIQUE AND RESULTS**

*Amit Maydeo*

16.25 Discussion

**16.30 TECHNICAL LECTURE:**

Introduction (Presenter): *Amit Maydeo*

ERCP Technique: *tips and tricks for selective biliary cannulation and how to manage complications*

*Guido Costamagna*

**THEORETICAL SESSION 2: GOODIES OF KNOWLEDGE (WHO WOULD HAVE THOUGHT?)**

Chairs: *Elisabetta Buscarini ■ Mohamed Ali El Nady ■ Aldo Manca*

**16.55 AUTOIMMUNE AND PARADUODENAL PANCREATITIS: TWO CHALLENGING DIFFERENTIAL DIAGNOSES**

*Luca Barresi*

17.15 Discussion

**17.20 THE ENDO-HEPATOLOGY CONCEPT**

*Andrada Seicean*

17.40 Discussion

**17.45 PANCREATIC CYSTIC LESIONS: EUS ROLE IN DIAGNOSIS, FOLLOW-UP AND TREATMENT**

*Laurent Palazzo*

18.05 Discussion

**18.10 COMMENTS FROM THE AUDIENCE AND CLOSING REMARKS FOR THE FIRST DAY**

*Claudio Giovanni De Angelis*

18.30 End of the first day



# SCIENTIFIC PROGRAM

DAY 2

Friday | 16 December 2022

## 08.45 LIVE SESSION 3

Live transmission from Turin: *Molinette Hospital*

Chairs: *Pierre Deprez* ■ *Roberto Di Mitri* ■ *Cem Kalayci*

Live operators and Tutors: *Andrea Anderloni, Paolo Giorgio Arcidiacono, Helga Bertani, Kenneth Binmoeller, Mauro Bruno, Stefania Caronna, Guido Costamagna, Wilma Debernardi Venon, Francesco Maria Di Matteo, Vinay Dhir, Carlo Fabbri, Pietro Fusaroli, Silvia Gaia, Chiara Giordanino, Mitsuhiro Kida, Alessandro Lavagna, Amit Maydeo, Massimiliano Mutignani, Nico Pagano, Laurent Palazzo, Ilaria Tarantino, Thomas Togliani, Peter Vilmann.*

Anesthesiologists Team: *Roberto Balagna, Christoph Meier, Rosalba Oliva, Angelo Panio, Andrea Pusineri*

Pathologists Team: *Mauro Papotti, Francesca Maletta, Chiara Pitino, Denisa Petronela Filip*

10.30 Open Coffee

## 11.00 CLINICAL LECTURE:

Introduction (Presenter): *Rodica Gincul*

*Malignant and benign hepato-biliary pathology: diagnosis, staging and Therapy*

*Pierre Deprez*

## 11.25 LIVE SESSION 4

Live transmission from Turin: *Molinette Hospital*

Chairs: *Paolo Bocus ■ Alberto Larghi ■ Leonardo Sosa Valencia*

Live operators and Tutors: *Andrea Anderloni, Paolo Giorgio Arcidiacono, Helga Bertani, Kenneth Binmoeller, Mauro Bruno, Stefania Caronna, Guido Costamagna, Wilma Debernardi Venon, Francesco Maria Di Matteo, Vinay Dhir, Carlo Fabbri, Pietro Fusaroli, Silvia Gaia, Chiara Giordanino, Mitsuhiro Kida, Alessandro Lavagna, Amit Maydeo, Massimiliano Mutignani, Nico Pagano, Laurent Palazzo, Ilaria Tarantino, Thomas Togliani, Peter Vilmann.*

Anesthesiologists Team: *Roberto Balagna, Christoph Meier, Rosalba Oliva, Angelo Panio, Andrea Pusineri*

Pathologists Team: *Mauro Papotti, Francesca Maletta, Chiara Pitino, Denisa Petronela Filip*

14.00 Light Lunch

## THEORETICAL SESSION 3: CURRENT SITUATION AND A LOOK INTO THE FUTURE

Chairs: *Andrea Anderloni ■ Maria Caterina Parodi ■ Laurent Palazzo*

15.00 THE RISE OF AUGMENTED EUS IMAGING (CH-EUS, EUS-EG AND AI) IN HEPATOBILIO-PANCREATIC PATHOLOGY

*Pietro Fusaroli*

15.20 Discussion

15.25 GUT MICROBIOME AND BILIOPANCREATIC PATHOLOGY: SOMETHING NEW IN THE LAST TWO YEARS?

*Marcantonio Gesualdo - Marco Sacco*

15.45 Discussion

15.50 DIAGNOSTIC AND THERAPEUTIC MANAGEMENT OF PANCREATIC NEUROENDOCRINE TUMORS AND LIVER METASTASES

*Rodica Gincul*

16.10 Discussion

16.15 CLINICAL LECTURE:

Introduction (Presenter): *Rodolfo Rocca*

The IBD Patient: *endoscopic diagnosis, clinical management and bilio-pancreatic manifestations or complications*

*Marco Daperno*

16.30 Open Coffee

## THEORETICAL SESSION 4: ROLE OF ENDOSCOPY IN BILIOPANCREATIC PATHOLOGY (THE SUMMA THEOLOGICA OF THE UPDATED KNOWLEDGE)

Chairs: *László Czákó* ■ *Vinay Dhir* ■ *Carlo Fabbri*

**16.40** ENDOSCOPIC PAPILLECTOMY: INDICATIONS, TECHNIQUE, RESULTS. ANY ROLE FOR EUS?

*Massimiliano Mutignani*

17.00 Discussion

**17.10** PANCREATIC SOLID LESION: DIFFERENTIAL DIAGNOSIS, WHEN AND HOW TO BIOPSY (FNA, FNB OR SOMETHING BETTER?)

*Peter Villman*

17.30 Discussion

**17.35** HOW TO FIND EARLY STAGE PANCREATIC CANCER: TIME FOR PANCREATIC CANCER SCREENING

*Mitsuhiro Kida*

17.55 Discussion

**18.00** CLOSING REMARKS

*Claudio Giovanni De Angelis*

# SCIENTIFIC PROGRAM

**DAY 3**

**Saturday | 17 December 2022**

## **THEORETICAL SESSION 5 AND VIDEOSSESSION: DIAGNOSTIC AND THERAPEUTIC EUS**

Chairs: *Francesco Maria Di Matteo* ■ *Mitsuhiro Kida* ■ *Alessandro Repici*

### **08.45 PROBE-BASED CONFOCAL LASER ENDOMICROSCOPY: TECHNIQUE, INDICATIONS AND RESULTS IN BILIOPANCREATIC PATHOLOGY**

*Helga Bertani*

**09.00** Discussion

### **09.05 MINIPROBES IN BILIO-PANCREATIC DISEASES (EDUS/IDUS): THE LOST WORLD?**

*Mauro Bruno*

**09.20** Discussion

### **09.25 PANCREATIC NEOPLASIAS. WHAT THE ENDOSONOGRAPHER CAN DO: ABLATE THE TUMOR AND TREAT THE PAIN**

*Paolo Giorgio Arcidiacono*

**09.40** Discussion

**09.45** Open Coffee

### **09.45 VIDEO-SESSION: SELECTED VIDEO-COMMUNICATIONS OR A SELECTION OF THE BEST LIVE CASES**

Presenters: *Silvia Gaia* ■ *Mohamed Ali El Nady* ■ *Thomas Togliani*

**11.15 FAREWELL LECTURE:**

Introduction (Presenter): *Kenneth Binmoeller*  
ERCP in the third millennium: how far can we arrive?  
*Guido Costamagna*

**THEORETICAL SESSION 6: THERAPEUTIC EUS**

Chairs: *Andrada Seicean* ■ *Nico Pagano* ■ *Peter Vilmann*

**11.40 EUS-GUIDED PANCREATIC COLLECTIONS DRAINAGE AND NECROSECTOMY**

*Manu K. Najar*

**11.55 Discussion**

**12.00 EUS-GUIDED BILIARY AND PANCREATIC ACCESS: READY TO RETIRE NOT ONLY THE PTBD BUT EVEN THE ERCP?**

*Vinay Dhir*

**12.15 Discussion**

**12.20 THE NEW EUS-GUIDED ANASTOMOSES**

*Ilaria Tarantino*

**12.35 Discussion**

**12.40 FAREWELL LECTURE:**

Introduction (Presenter): *Claudio Giovanni De Angelis*  
Therapeutic EUS: how far will we go?  
*Kenneth Binmoeller*

**13.05 COMMENTS FROM THE AUDIENCE, CLOSING REMARKS**

*Claudio Giovanni De Angelis*

**13.05 CME-EVALUATION TEST**

**13.05 END OF THE COURSE**

# GENERAL INFORMATION

## CONGRESS VENUE

NH HOTEL TORINO CENTRO  
Auditorium • Congress Center  
Corso Vittorio Emanuele, 104  
Telephone: +39 011 57521

Live transmission from Endoscopy Unit,  
Sc Gastroenterologia U, Molinette Hospital  
Corso Bramante, 88 - 10126 Turin

## ORGANIZING SECRETARIAT



Viale della Libertà, 56 - 90143 Palermo, Italy  
Telephone: +39 091 772 53 39 - Fax +39 091 772 54 34  
e-mail [segreteria@meetingandcreative.com](mailto:segreteria@meetingandcreative.com)  
Website [meetingandcreative.com](http://meetingandcreative.com)

The Organizing Secretariat will be open for participants at the following times:

Thursday, December 15 from 7 a.m. to 7 p.m.  
Friday, December 16 from 7.30 a.m. to 7 p.m.  
Saturday, December 17 from 7.30 a.m. to 2 p.m.

## LANGUAGE

The official language is English

## REGISTRATION FEE AND DEADLINE

The registration form is available on the website [eus-ercp2022.meetingandcreative.com](http://eus-ercp2022.meetingandcreative.com)  
Registration is reserved to 150 participants  
Registration Fee and Deadline - Registration fees VAT 22% included

# GENERAL

## INFORMATION

### FIRST DEADLINE SEPTEMBER 12th, 2022

Medical Doctor	€ 610,00
Egeus and ESGE individual member	€ 488,00
Resident Physicians /Under 40	€ 210,00
Nurses	€ 61,00

### LAST DEADLINE DECEMBER 1st, 2022

Medical Doctor	€ 700,00
Egeus and ESGE individual member	€ 560,00
Resident Physicians /Under 40	€ 260,00
Nurses	€ 100,00

#### Registration fee includes:

Unlimited entrance to the scientific sessions, Congress kit, certificate of attendance, CME certificate, final program, conference documentation and name badge, coffee-breaks, working lunches as indicated in the program. The Secretariat has reserved a block of rooms in some hotels of Turin, not far from the Conference Venue.

#### Hotel prices:

##### NH TORINO CENTRO (CONGRESS VENUE)

\*Room Classic DUS € 129,00

\*Room Classic DBL € 149,00

\*Room Superior DUS € 159,00

\*Room Superior DBL € 179,00

##### NH COLLECTION PIAZZA CARLINA

\*Room Superior DUS € 159,00

\*Room Superior DBL € 179,00

\*Room Premium DUS € 189,00

\*Room Premium DBL € 209,00

\*Prices for guest for one night, city tax not included in the rate € 3,70

# GENERAL INFORMATION

## PAYMENT:

Registration fee can be paid by:

- Bank Transfer to (also available on [eus-ercp2022.meetingandcreative.com](https://eus-ercp2022.meetingandcreative.com)):

Meeting & Creative S.r.l.  
Intesa San Paolo, Ag. - Piazza Vittorio Veneto, 2D - 90143 Palermo, Italy  
IBAN Code IT36Y0306904632100000015478  
SWIFT CODE BCITITMM

A copy of the bank transaction must be sent together with the registration form to Meeting & Creative by e-mail.

The sender's full name and address must be clearly stated in the transfer order as well as the payment purpose.

- PayPal on [eus-ercp2022.meetingandcreative.com](https://eus-ercp2022.meetingandcreative.com)

If billing address is different from participant information, you can request your invoice by mailing the organizing secretariat at [segreteria@meetingandcreative.com](mailto:segreteria@meetingandcreative.com), that will answer and confirm your registration within 72 hours after your request.

## CONGRESS BADGES

Each participant may collect the badge at the registration desk.

Participants are kindly requested to wear their badge during all conference activities and social events.

Red colour:	Speakers and Chairs
Blue colour:	Participants
Yellow colour:	Pharmaceutical companies



# SCIENTIFIC INFORMATION

## THE EVENT WILL BE BROADCAST VIA WEB BROADCAST

All the speakers should inform the Slide Center in charge if their presentation contains details not published yet, in order to hide them during the live web.

## SPEECHES IN THE AUDITORIUM

Time of presentation is 15/20 minutes for the speech, as indicated in the scientific program. Speakers must present scientific material only in power point format (16:9). Lap top computers are not allowed. Only one system will automatically provide to forward into the Auditorium the entire projection.

## SLIDE CENTER

The Slide Center is available in "Sala Quasimodo" 1st Floor. Speakers are requested to load their slides in the Slide Center at least 2 hours before presentation (or, if their session starts at 08.30 a.m., by 6.30 p.m., on the previous day).

### The opening hours of the slide center are:

*Thursday, December 15 from 7.30 a.m. to 7.00 p.m.*

*Friday, December 16 from 7.30 a.m. to 7.00 p.m.*

*Saturday, December 17 from 7.30 a.m. to 2.00 p.m.*

## CME

ID Event: 366206

The Provider Associazione Sinapsy Soluzioni e Servizi Integrati ID. 3017 according to the present Ministerial set of rules has assigned 14 points to Congress 6th EUS-ERCP connection: the "EURCP" concept - An International Endoscopic Hybrid EGEUS event.

### Credits earning are reserved to:

150 Participants (Physicians - Nurses)

Disciplines: Gastroenterology and Digestive Endoscopy, General Surgery, Internal Medicine, Medical Oncology, Anatomical Pathology, Anesthesiology, Reanimation and Intensive Care

## CERTIFICATE OF ATTENDANCE

Certificates of Attendance in quality of Speakers/Chairs/Participants will be available at the Organizing Secretariat Desk.

# EXHIBITION HALL & PLENARY ROOM

## GROUND FLOOR

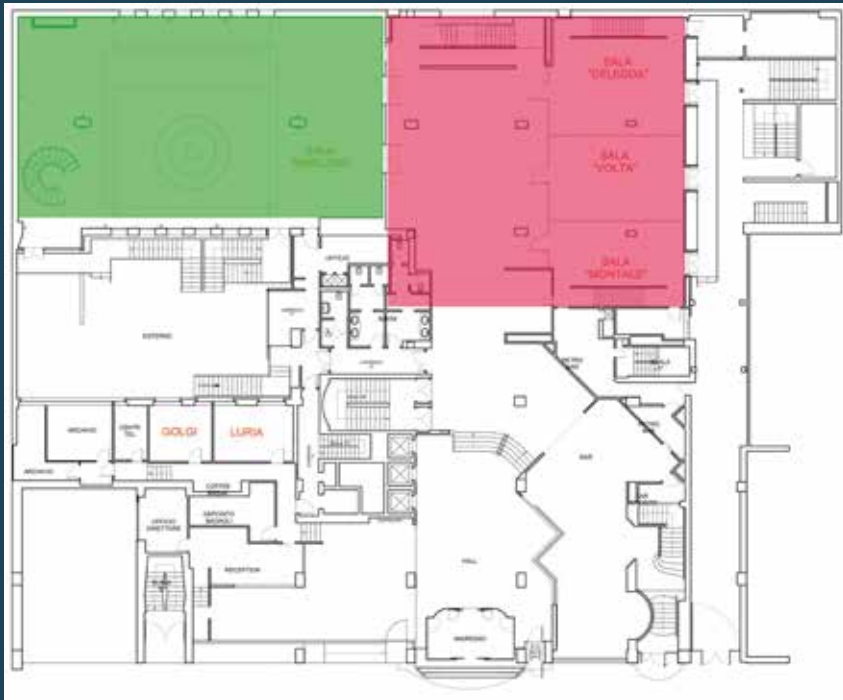

EXHIBITION



PLENARY ROOM



# SLIDE CENTER & SERVICES

## 1ST FLOOR



SLIDE CENTER



PLENARY  
STREAMING ROOM



LUNCH & COFFEE  
BREAK AREAS



